

THE
EDMENTS
BUILDING

SUITE 209

Located on level 2, Suite 209 of approximately 32sqm

38 Gawler Place, Adelaide
Suite 209

ESTIMATED NETT LETTABLE AREA:
32.1 sq. metres

Complies with the PCA Method of Measurement

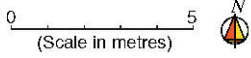

THE
EDMENTS
BUILDING

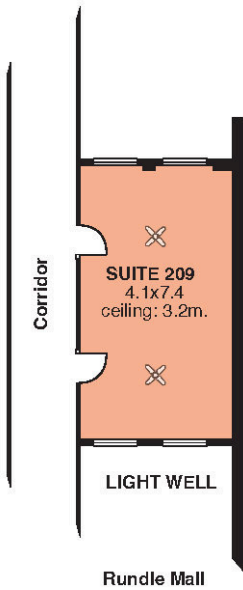
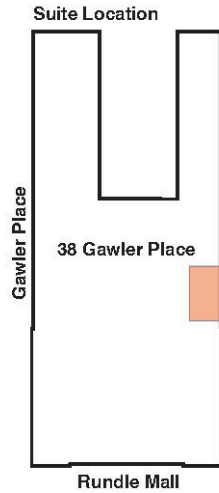

AVAILABLE
NOW

FEATURES



Freshly painted



Natural light



Fully carpeted



Quiet location

RENTAL

The Edments Building provides competitive rental costings which include all statutory charges. Electricity is charged separately and based on tenant's consumption.

CONTACT

For enquiries or to arrange an inspection, please contact building management at 8120 0900 or via email at admin@edmentsbuilding.com.au.

